

FEATURES:

- Performance Conforms to ANSI/TIA-568.2-D, ISO/IEC 11801-1 and EN50173-1 Category 6A Specification
- Support T568 A&B Wiring & Easy Installation
- Offers total solution of your local area networking
- Dual IDC connector can accept 23-26 AWG solid and stranded cables.
- Terminate without using any punch tools.
- RoHS compliant

**APPLICATIONS:**

- 10GBASE-T Ethernet
- 1000BASE-TX Gigabit Ethernet
- 1000BASE-T Gigabit Ethernet
- 100BASE-TX Fast Ethernet.
- 10 BASE-T Ethernet.
- Voice, Video and other applications.

CHARACTERISTICS:

Dielectric Strength	1000V RMS for 1min(for IEC 60603) 500V RMS for 1min(for UL1863)
Insulation Resistance	500M Ω min
Contact Resistance	20m Ω per contact
Temperature Range	-10°C to 60°C max
Humidity	10%~65%
Admissible Conductor	23AWG ~ 26AWG insulation wire
Material Flame Rating	PC, UL94 V-0
Jack contact	Phosphor bronze, 50 μ inch gold plated over nickel plated in contact area Operating life: Minimum 750 insertions
IDC Contacts	Tinned 100 μ Inch nickel plated over phosphor bronze Operating life: Minimum 250 Re-terminations

TYPICAL PERFORMANCE:

Channel Performance Data for 10G 6A Unshielded Solution

PSNEXT

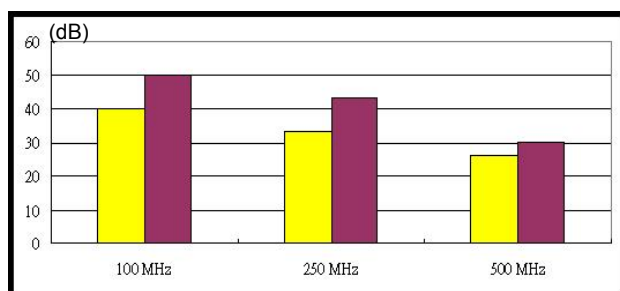

PSANEXT

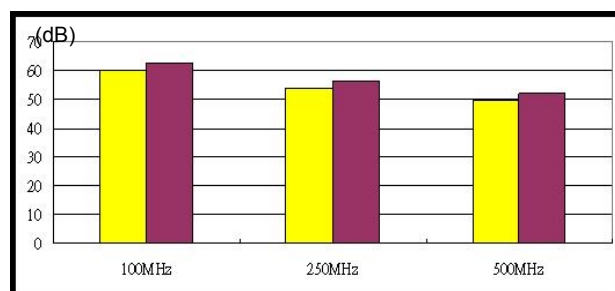

Return Loss

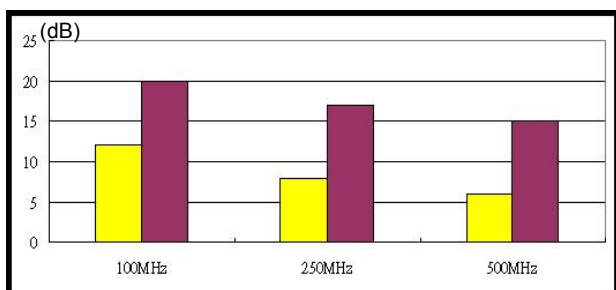

Insertion Loss

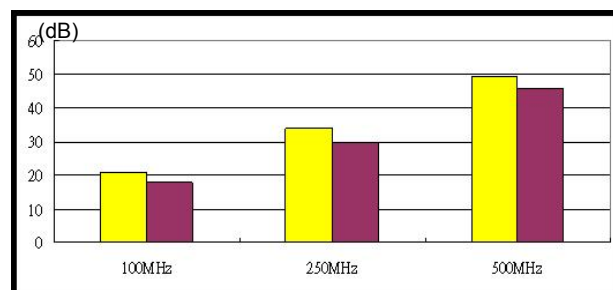

Cat.6A Limit **Typical**

Premium Line Systems GmbH reserves the right to change specifications without prior notice.

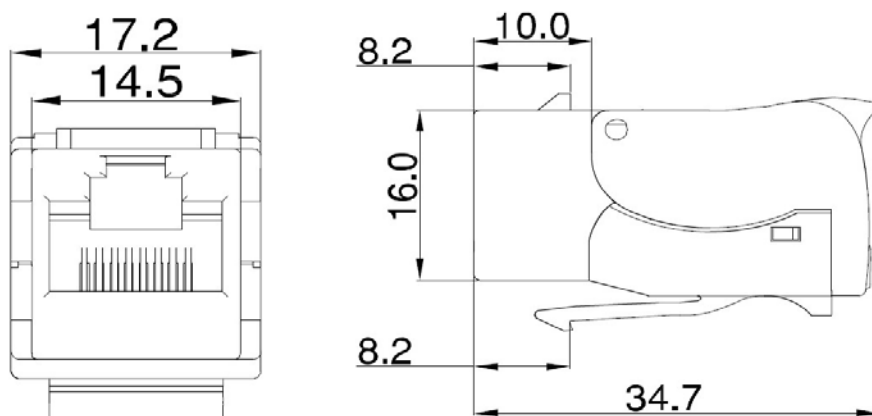
DRAWING:***ORDERING INFORMATION:***

Part NO.	109114010
Description	Cat.6A 90° Tooless Unshielded Keystone Jack
Packing	1pc/ PE bag, 50pcs/box, 500pcs/ carton
	carton size 53.8*35.2*27 cm

Premium-Line Systems GmbH. Rosenheimer Str.89 D-83064 Raubling. Germany

► TEL:+49(0)8035 9836 0 ► Fax:+49(0)8035 9836 22

Premium Line Systems GmbH reserves the right to change specifications without prior notice.